

How to Setup Wifi on a Windows 8 Mobile Phone

These instructions have been prepared using a Lumia 920 – screen shots and instructions may vary slightly for different makes/models.

1. Go to “Settings”

Tap on the Cog icon on Windows Tiles main screen, or swipe to get to the program menu on the right

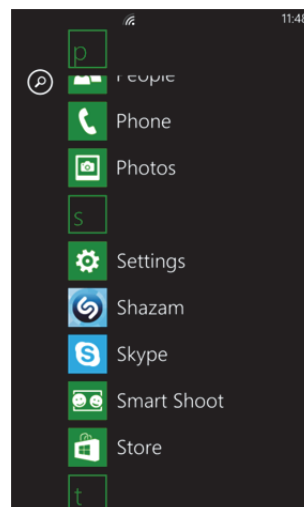

2. Tap "WiFi" from the System tab of Settings

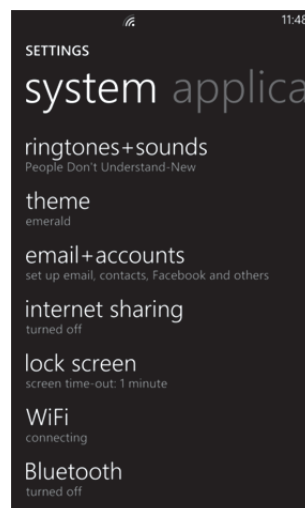

3. If Wifi Networking is “Off” then tap the slider on the right to turn it On

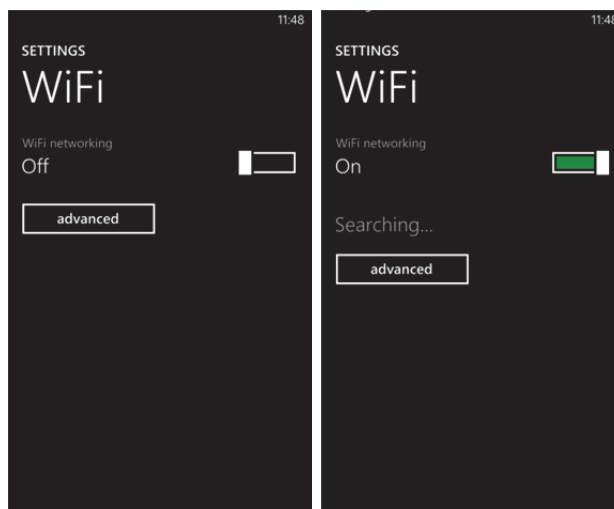

How to Setup Wifi on a Windows 8 Mobile Phone

- Once it has searched/discovered networks select the Wifi network you want to connect to (eg eduroam or staff-curtin)

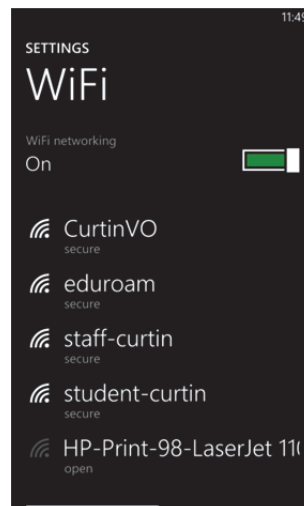

- Type in your OASIS username and password

Username: <Your OASIS Username> eg 256547h

Password: <Your OASIS Password>

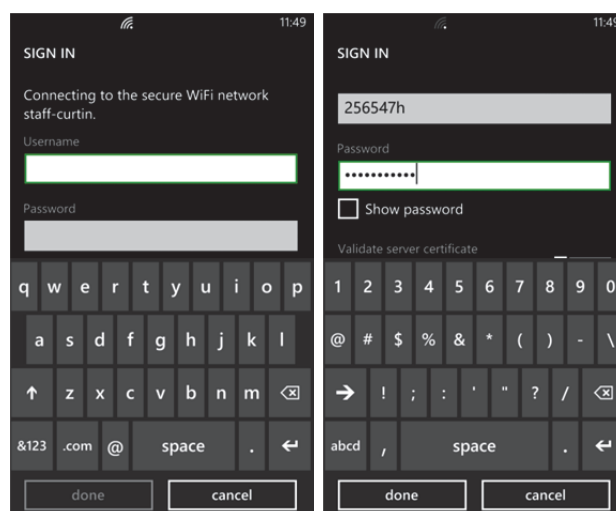

- Tap "**Done**" at the bottom of the screen

- If it prompts you to confirm/continue connecting tap "**yes**"

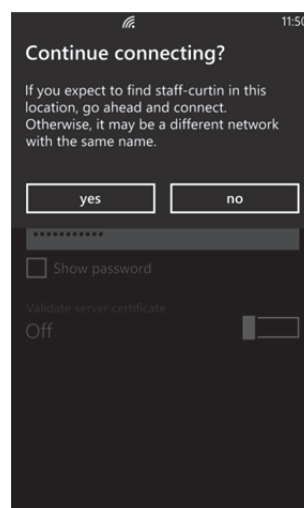

How to Setup Wifi on a Windows 8 Mobile Phone

8. If successful, you should see “connected” beside the WiFi network you chose.

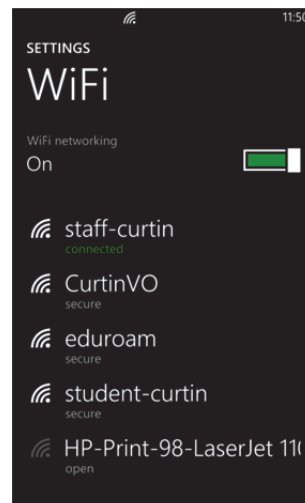

If required, please contact the **CITS Service Desk** for further assistance:

<http://cits.curtin.edu.au/support>

Phone: (+61 8 9266) 9000

There are a number of ways you can contact the CITS Service Desk for help:

1. Curtin staff can lodge a service call by completing the [Service Desk Web Form](#)
2. Phone us on +61 8 9266 9000
3. Visit the Service Desk on Bentley Campus in [Building 200b](#) (next to the Bookshop)
4. Send an email to service.desk@curtin.edu.au

Phone Support:

7:30am - 9:00pm, Monday to Friday

Counter Support Hours:

Everyday Curtin is Open	8:00am - 5:00pm, Monday to Friday
AV pickups (Teaching Weeks)	7:30am - 5:00pm, Monday to Friday